

Cat.
A

Heavy Duty Anchor HDA



Description

Heavy Duty Anchors are a high performance anchor specifically designed for medium to heavy duty applications on concrete. In-situ installation time is reduced due to the benefit of being a through fixing.

Applications such as heavy machinery installations, cladding and structural steel work make this an ideal choice for all installers. Version types on offer are Loosebolt and Countersunk in Zinc Plated with Bolt Projecting in both Zinc and Stainless Steel.

Applications

- Structural Steelworks
- Heavy Machinery
- Structural Cladding
- Safety Barriers
- Heavy Duty Bracketry

Features & Benefits

- Fast Installation
- Long Life Protection
- External Usage
- Increased Load Potential
- Proof Test Anchor on Installation
- Through Fixing
- Zinc Plating
- High Tensile Components
- Torque Controlled

Installation Guide

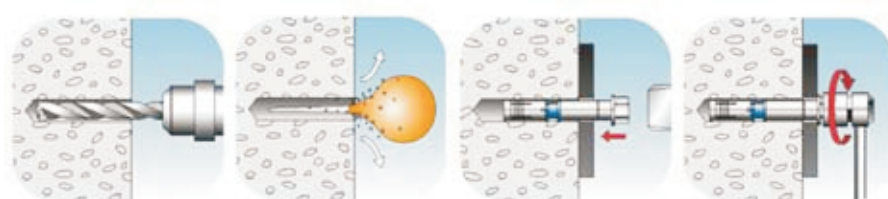

www.safeguardanchors.com

Heavy Duty Anchor Loosebolt Head HDAL

Product Code	Thread Diameter (mm)	Hole Diameter (mm)	Length (mm)	Fastening Thickness (mm)	Box Quantity
HDA10010L	6	10	65	10	50
HDA10025L	6	10	80	25	50
HDA10050L	6	10	110	50	50
HDA12010L	8	12	80	10	50
HDA12025L	8	12	100	25	50
HDA12050L	8	12	125	50	50
HDA14010L	10	14	95	10	25
HDA14025L	10	14	105	25	25
HDA14050L	10	14	135	50	25
HDA18010L	12	18	105	10	20
HDA18025L	12	18	120	25	20
HDA18050L	12	18	140	50	20
HDA24010L	16	24	125	10	10
HDA24025L	16	24	145	25	10
HDA24050L	16	24	165	50	10
HDA28010L	20	28	155	10	10
HDA28025L	20	28	170	25	10
HDA28050L	20	28	195	50	10

Heavy Duty Anchor Projecting Head HDAP

Product Code	Thread Diameter (mm)	Hole Diameter (mm)	Length (mm)	Fastening Thickness (mm)	Box Quantity
HDA10010P	6	10	75	10	50
HDA10025P	6	10	90	25	50
HDA10050P	6	10	120	50	50
HDA12010P	8	12	90	10	50
HDA12025P	8	12	110	25	50
HDA12050P	8	12	135	50	50
HDA14010P	10	14	110	10	25
HDA14025P	10	14	120	25	25
HDA14050P	10	14	150	50	25
HDA18010P	12	18	120	10	20
HDA18025P	12	18	135	25	20
HDA18050P	12	18	155	50	20
HDA24010P	16	24	145	10	10
HDA24025P	16	24	165	25	10
HDA24050P	16	24	185	50	10
HDA28010P	20	28	180	10	10
HDA28025P	20	28	195	25	10
HDA28050P	20	28	220	50	10

Heavy Duty Anchor Flat Head HDAF

Product Code	Thread Diameter (mm)	Hole Diameter (mm)	Length (mm)	Fastening Thickness (mm)	Box Quantity
HDA12010F	8	12	85	10	50
HDA12025F	8	12	105	25	50
HDA12050F	8	12	130	50	50
HDA14010F	10	14	100	10	25
HDA14025F	10	14	110	25	25
HDA14050F	10	14	140	50	25
HDA18010F	12	18	110	10	20
HDA18025F	12	18	125	25	20
HDA18050F	12	18	145	50	20

Cat.
B

Universal Screw Bolt USB

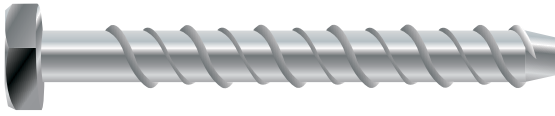

Description

This is based on an established principle within the fixing and fastening industry. Using threads in metal is standard practice for fastening within the engineering industry, as is using woodscrews to cut their thread into wood within the construction materials including concrete, stone, brick and block. This self-tapping action enables a positive and safe anchorage to be achieved, with the substrate becoming the nut to the Universal Screw Bolt. Thereby, a tried and tested method of fixing for materials and wood is applied to a broader selection of construction materials.

Applications

- Signs
- Aerials
- Seating
- Fencing
- Racking
- Staircases
- Hand Rails
- Conveyors
- Scaffolding Ties
- Temporary Fixings
- Ladder Restraints

Features & Benefits

- Self tapping multi- substrate anchor
- Thread designed to provide positive anchorage into the substrate
- Thread provides safe anchorage over full embedment of anchor
- Threaded anchorage is not subject to expansion pressure and maintains the fx without preload.
- “No expansion” gives close to edge fixing ability
- Single Thread designed to give maximum grip with minimum insertion torque

Installation Guide

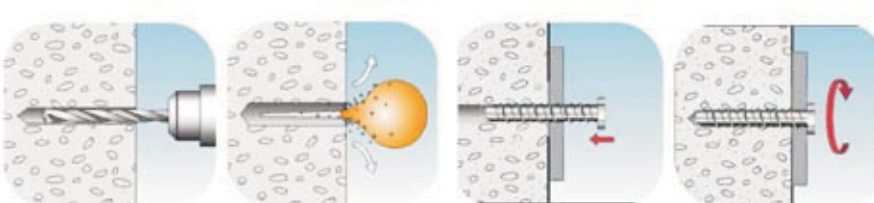

Universal Screw Bolt USB



Cat.
B

Category **B** Medium Duty Anchors

Product Code	Total Length (mm)	Hole Diameter (mm)	Thread Length (mm)	Fastening Thickness (mm)	Box Quantity
USB06030	30	5	30	5	200
USB06040	40	5	40	10	100
USB06050	50	5	50	20	100
USB06075	75	5	75	45	100
USB06100	100	5	95	70	100
USB75050	50	6	50	20	100
USB75075	75	6	75	45	100
USB75100	100	6	95	55	100
USB75120	120	6	95	75	100
USB75130	130	6	95	85	100
USB75150	150	6	95	105	100
USB10060	60	8	60	20	100
USB10075	75	8	75	35	100
USB10100	100	8	95	60	100
USB12060	60	10	60	10	50
USB12075	75	10	75	25	50
USB12100	100	10	95	50	50
USB12150	150	10	95	100	20
USB14075	75	12	75	15	20
USB14100	100	12	95	40	20
USB14130	130	12	95	70	20
USB14150	150	12	95	90	20
USB14200	200	12	95	140	20
USB16100	100	14	-	-	10
USB16150	150	14	-	-	10
USB16200	200	14	-	-	10
USB18100	100	16	-	-	10
USB18150	150	16	-	-	10
USB18200	200	16	-	-	10



Wedge Anchor WA

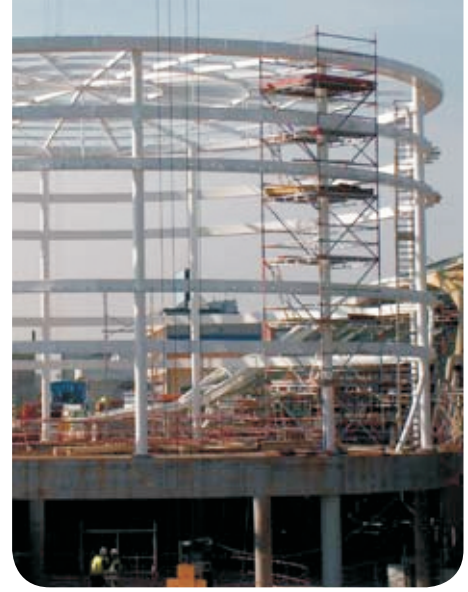

Description

This is designed for easy installation for offers performance in concrete, especially in relationship to shear forces. The comprehensive range of diameters and lengths fulfil the majority of applications for the installer offering a cost effective fixing. Zinc plated versions allow installation in both indoor and outdoor environments.

Applications

- Structural Steelworks & Structural Cladding
- Heavy Machinery & Bracketry
- Safety Barriers & Ballustrading

Features & Benefits

- Fast Installation & High Shear loads
- High Corrosion Resistance with Stainless Steel
- Proof Test Anchor on Installation
- Full Thread Diameter & Torque Controlled

Installation Guide

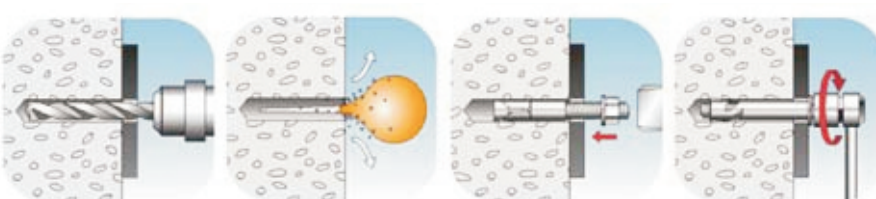

Wedge Anchor Cold Forged WACF

Product Code	Length (mm)	Thread Length (mm)	Hole Depth (mm)	Fastening Thickness (mm)	Box Quantity
WACF06045S	45	20	35	5	100
WACF06055S	55	30	35	15	100
WACF06065S	65	30	35	25	100
WACF06085S	85	30	35	45	100
WACF08050S	50	20	40	5	100
WACF08065S	65	35	40	20	100
WACF08080S	80	50	40	35	50
WACF08095S	95	60	40	50	50
WACF08115S	115	70	40	70	50
WACF08130S	130	85	40	85	50
WACF10065S	65	30	50	8	50
WACF10075S	75	40	50	18	50
WACF10090S	90	55	50	33	50
WACF10105S	105	65	50	50	50
WACF10120S	120	85	50	63	20
WACF10150S	150	85	50	90	20
WACF12080S	80	35	65	12	20
WACF12090S	90	35	65	12	20
WACF12100S	100	50	65	25	20
WACF12110S	110	60	65	35	20
WACF12120S	120	70	65	45	20
WACF12140S	140	80	65	65	20
WACF12160S	160	80	65	85	20
WACF12180S	180	80	65	105	20
WACF16105S	105	45	85	13	20
WACF16125S	125	65	85	30	20
WACF16150S	150	85	85	55	20
WACF16175S	175	85	85	80	20
WACF16220S	220	85	85	125	20

Wedge Anchor Machined Steel WAMS**Wedge Anchor Machined Stainless Steel WAMSS**

Product Code	Length (mm)	Thread Length (mm)	Hole Depth (mm)	Fastening Thickness (mm)	Box Quantity
WAM06045S	45	20	35	5	100
WAM06055S	55	30	35	15	100
WAM06085S	85	30	35	45	100
WAM08050S	50	20	40	5	100
WAM08065S	65	35	40	20	100
WAM08080S	80	50	40	35	50
WAM08090S	90	60	40	45	50
WAM08100S	100	70	40	55	50
WAM08130S	130	85	40	85	50
WAM10065S	65	30	50	8	50
WAM10075S	75	40	50	18	50
WAM10090S	90	55	50	33	50
WAM10120S	120	85	50	63	20
WAM12090S	90	35	65	12	20
WAM12100S	100	50	65	25	20
WAM12110S	110	60	65	35	20
WAM12120S	120	70	65	45	20
WAM12140S	140	80	65	65	20
WAM12180S	180	80	65	105	20
WAM16105S	105	45	85	13	20
WAM16125S	125	65	85	30	20
WAM16150S	150	85	85	55	20
WAM16175S	175	85	85	80	20
WAM20130S	130	50	100	20	10
WAM20160S	160	50	100	50	10
WAM20220S	220	50	100	105	10
WAM24180S	180	60	105	40	10
WAM24260S	260	60	105	125	10



Wedge Anchor Double Clip White Zinc WAD WZ

Wedge Anchor Double Clip Stainless Steel WAD SS A4-316



Product Code	Length (mm)	Hole Depth (mm)	Fastening Thickness (mm)	Box Quantity
WAD06050WZ	50	35	5	-
WAD06070WZ	70	50	10	-
WAD06100WZ	100	50	40	-
WAD08060WZ	60	43	5	-
WAD08082WZ	82	55	15	-
WAD08122WZ	122	55	55	-
WAD08167WZ	167	55	100	-
WAD10070WZ	70	50	5	-
WAD10090WZ	90	60	15	-
WAD10120WZ	120	60	45	-
WAD10165WZ	165	60	90	-
WAD10210WZ	210	60	140	-
WAD10230WZ	230	60	160	-
WAD12080WZ	80	57	5	-
WAD12113WZ	113	80	15	-
WAD12153WZ	153	80	55	-
WAD12183WZ	183	80	85	-
WAD12203WZ	203	80	105	-
WAD12243WZ	243	80	145	-
WAD12258WZ	258	80	160	-
WAD16110WZ	110	77	10	-
WAD16153WZ	153	100	30	-
WAD16198WZ	198	100	75	-
WAD16223WZ	223	100	100	-
WAD16253WZ	253	100	130	-
WAD16293WZ	293	100	170	-
WAD16323WZ	323	100	200	-
WAD20130WZ	130	90	10	-
WAD20175WZ	175	120	25	-
WAD10230WZ	230	120	80	-
WAD20370WZ	370	120	220	-
WAD24250WZ	250	180	40	-

Wedge Anchor Steel WAS HDG Hot dipped galvanised 45 microns



Product Code	Length (mm)	Thread Length (mm)	Hole Depth (mm)	Fastening Thickness (mm)	Box Quantity
WAS06045HDG	45	20	35	5	100
WAS06055HDG	55	30	35	15	100
WAS06085HDG	85	60	35	45	100
WAS08050HDG	50	20	40	5	100
WAS08065HDG	65	35	40	20	100
WAS08080HDG	80	50	40	35	50
WAS08090HDG	90	60	40	45	50
WAS08100HDG	100	50	40	55	50
WAS08130HDG	130	85	40	85	50
WAS10065HDG	65	30	50	8	50
WAS10075HDG	75	40	50	18	50
WAS10090HDG	90	55	50	33	50
WAS10120HDG	120	80	50	63	20
WAS12090HDG	90	30	65	12	20
WAS12100HDG	100	50	65	25	20
WAS12110HDG	110	70	65	35	20
WAS12120HDG	120	80	65	45	20
WAS12140HDG	140	100	65	65	20
WAS12180HDG	180	45	65	105	20
WAS16105HDG	105	65	85	13	20
WAS16125HDG	125	80	85	30	20
WAS16150HDG	150	80	85	55	20
WAS16175HDG	175	90	85	80	20
WAS20125HDG	125	50	100	20	10
WAS20160HDG	160	50	100	50	10
WAS20215HDG	215	50	100	105	10

Wedge Anchor Double Clip Hot Dipped Galvanised WAD HDG



Product Code	Length (mm)	Hole Depth (mm)	Fastening Thickness (mm)	Box Quantity
WAD06050HDG	50	35	5	-
WAD06070HDG	70	50	10	-
WAD06100HDG	100	50	40	-
WAD08060HDG	60	43	5	-
WAD08082HDG	82	55	15	-
WAD08122HDG	122	55	55	-
WAD08167HDG	167	55	100	-
WAD10070HDG	70	50	5	-
WAD10090HDG	90	60	15	-
WAD10120HDG	120	60	45	-
WAD10165HDG	165	60	90	-
WAD10210HDG	210	60	140	-
WAD10230HDG	230	60	160	-
WAD12080HDG	80	57	5	-
WAD12113HDG	113	80	15	-
WAD12153HDG	153	80	55	-
WAD12183HDG	183	80	85	-
WAD12203HDG	203	80	105	-
WAD12243HDG	243	80	145	-
WAD12258HDG	258	80	160	-
WAD16110HDG	110	77	10	-
WAD16153HDG	153	100	30	-
WAD16198HDG	198	100	75	-
WAD16223HDG	223	100	100	-
WAD16253HDG	253	100	130	-
WAD16293HDG	293	100	170	-
WAD16323HDG	323	100	200	-
WAD20130HDG	130	90	10	-
WAD20175HDG	175	120	25	-
WAD10230HDG	230	120	80	-
WAD20370HDG	370	120	220	-
WAD24250HDG	250	180	40	-

Shield Anchor 2 Segment SAB

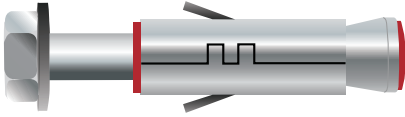

Description

The 2 Segment Shield Anchor is perhaps the most versatile of all fixings used by the majority of trades. Suitable for Brickwork, Medium or Dense Blockwork and Concrete. It is an ideal general purpose anchor that fulfils a large number of applications. The Shield version is particularly versatile when utilised with a wide variety of non-standard components, including special lengths of threaded rod where required.

Applications

- Machinery Installation
- Reinforcement
- Bracketry
- Racking & Storage
- Pipework
- Wall/Sole Plated

Features & Benefits

- Zinc Plated
- Steel Manufacture
- Variety of Head Styles
- Torque Controlled
- Partial Corrosion Resistance
- Fire Resistance
- Multi Style Customer Choice
- Proof Test Anchor on Installation

Installation Guide

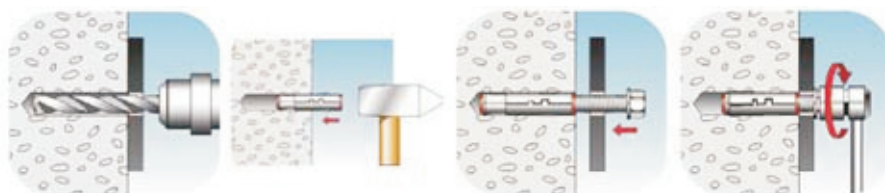

Shield Only SAB-S

Product Code	Length (mm)	Hole Diameter (mm)	Thread Diameter (mm)	Box Quantity
SAB06012S	50	12	6	100
SAB08014S	55	14	8	50
SAB10016S	65	16	10	50
SAB12020S	80	20	12	25
SAB16024S	90	24	16	10

Loosebolt SAB-L

Product Code	Bolt (mm)	Hole Diameter (mm)	Thread Diameter (mm)	Box Quantity
SAB06012L	50	12	6	50
SAB08014L	55	14	8	50
SAB10016L	80	16	10	50
SAB12020L	90	20	12	20
SAB16024L	100	24	16	10

Projecting SAB-P

Product Code	Stud (mm)	Hole Diameter (mm)	Thread Diameter (mm)	Box Quantity
SAB06012P	65	12	6	50
SAB08014P	75	14	8	50
SAB10016P	95	16	10	25
SAB12020P	115	20	12	20

Shield Anchor 3 Segment SAC

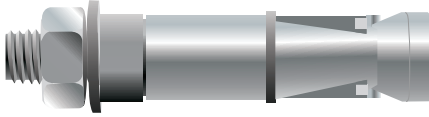

Description

The 3 Segment Shield Anchor is the bolt projecting version of the range utilising the shield assembly it offers a projecting length of threaded rod whereas the anchor can be installed in a wall and the fixture lifted in place. The range covers thread sizes from M6 to M16 in varying lengths.

Applications

- Machinery Installation
- Reinforcement
- Bracketry
- Racking & Storage
- Pipework
- Wall/Sole Plated

Features & Benefits

- Zinc Plated
- Steel Manufacture
- Variety of Head Styles
- Torque Controlled
- Partial Corrosion Resistance
- Fire Resistance
- Multi Style Customer Choice
- Proof Test Anchor on Installation

Installation Guide

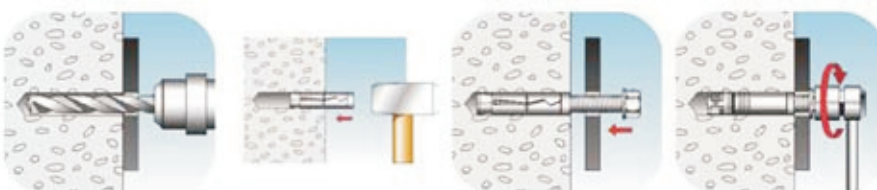

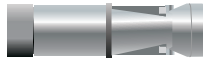
Shield Only SAC-S

Product Code	Hole Diameter (mm)	Shield Length (mm)	Thread Diameter (mm)	Hole Depth (mm)	Fastening Thickness (mm)	Bolt Length (mm)	Box Quantity
SAC06045S	12	45	6	50	-	-	50
SAC08050S	14	50	8	55	-	-	50
SAC10060S	16	60	10	65	-	-	50
SAC12075S	20	75	12	85	-	-	25
SAC16115S	25	115	16	125	-	-	10

Loosebolt SAC-L

Product Code	Hole Diameter (mm)	Shield Length (mm)	Thread Diameter (mm)	Hole Depth (mm)	Fastening Thickness (mm)	Bolt Length (mm)	Box Quantity
SAC06010L	12	45	6	50	10	55	50
SAC06025L	12	45	6	50	25	70	50
SAC06040L	12	45	6	50	40	85	50
SAC08010L	14	50	8	55	10	65	50
SAC08025L	14	50	8	55	25	80	50
SAC08040L	14	50	8	55	40	95	50
SAC10010L	16	60	10	65	10	75	50
SAC10025L	16	60	10	65	25	90	50
SAC10050L	16	60	10	65	50	115	50
SAC10075L	16	60	10	65	75	140	50
SAC12010L	20	75	12	85	10	90	25
SAC12025L	20	75	12	85	25	105	25
SAC12040L	20	75	12	85	40	120	25
SAC12060L	20	75	12	85	60	140	25
SAC16015L	25	115	16	125	15	135	10
SAC16030L	25	115	16	125	30	150	10
SAC16060L	25	115	16	125	60	180	10

Projecting SAC-P

Product Code	Hole Diameter (mm)	Shield Length (mm)	Thread Diameter (mm)	Hole Depth (mm)	Fastening Thickness (mm)	Bolt Length (mm)	Box Quantity
SAC06010P	12	45	6	50	10	65	50
SAC06025P	12	45	6	50	25	80	50
SAC06060P	12	45	6	50	60	115	50
SAC08010P	14	50	8	55	10	75	50
SAC08025P	14	50	8	55	25	90	50
SAC08060P	14	50	8	55	60	125	50
SAC10015P	16	60	10	65	15	90	50
SAC10030P	16	60	10	65	30	105	50
SAC10060P	16	60	10	65	60	135	25
SAC12015P	20	75	12	85	15	110	25
SAC12030P	20	75	12	85	30	125	25
SAC12075P	20	75	12	85	75	170	10
SAC16015P	25	115	16	125	15	150	10
SAC16035P	25	115	16	125	35	170	10
SAC16075P	25	115	16	125	75	210	10

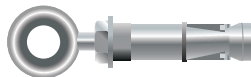
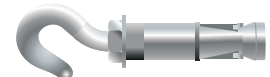
Eyebolt SAC-E**Hookbolt SAC-H**

Product Code	Hole Diameter (mm)	Shield Length (mm)	Thread Diameter (mm)	Hole Depth (mm)	Fastening Thickness (mm)	Bolt Length (mm)	Box Quantity
SAC06045E	12	45	6	50	-	-	50
SAC08050E	14	50	8	55	-	-	50
SAC10060E	16	60	10	65	-	-	50
SAC12075E	20	75	12	85	-	-	25

Shield Anchor 4 Segment SAD

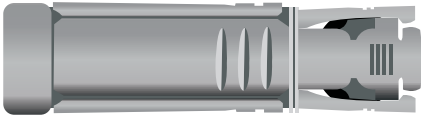

Description

The 4 Segment Shield Anchor is the bolt projecting version of the range utilising the shield assembly it offers a projecting length of threaded rod whereas the anchor can be installed in a wall and the fixture lifted in place. The range covers thread sizes from M6 to M16 in varying lengths.

Applications

- Machinery Installation
- Reinforcement
- Bracketry
- Racking & Storage
- Pipework
- Wall/Sole Plated

Features & Benefits

- Zinc Plated
- Steel Manufacture
- Variety of Head Styles
- Torque Controlled
- Partial Corrosion Resistance
- Fire Resistance
- Multi Style Customer Choice
- Proof Test Anchor on Installation

Installation Guide

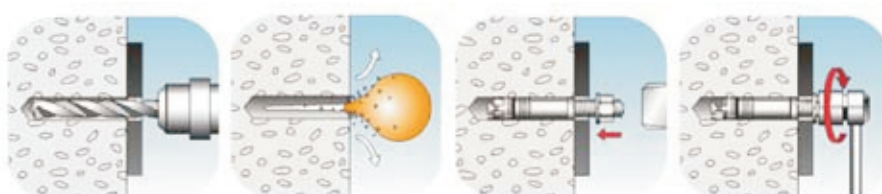

Shield Only SAD-S

Product Code	Hole Diameter (mm)	Shield Length (mm)	Thread Diameter (mm)	Hole Depth (mm)	Fastening Thickness (mm)	Bolt Length (mm)	Box Quantity
SAD06040S	10	40	6	45	-	-	50
SAD08050S	14	50	8	55	-	-	50
SAD10060S	16	60	10	65	-	-	50
SAD12080S	20	80	12	90	-	-	25
SAD16100S	25	100	16	110	-	-	10

Loosebolt SAD-L

Product Code	Hole Diameter (mm)	Shield Length (mm)	Thread Diameter (mm)	Hole Depth (mm)	Fastening Thickness (mm)	Bolt Length (mm)	Box Quantity
SAD06010L	12	45	6	50	10	55	50
SAD06025L	12	45	6	50	25	70	50
SAD06040L	12	45	6	50	40	80	50
SAD08010L	14	50	8	55	10	65	50
SAD08025L	14	50	8	55	25	75	50
SAD08040L	14	50	8	55	40	90	50
SAD10010L	16	60	10	65	10	75	50
SAD10025L	16	60	10	65	25	85	50
SAD10050L	16	60	10	65	50	110	50
SAD10075L	16	60	10	65	75	135	50
SAD12010L	20	75	12	85	10	95	25
SAD12025L	20	75	12	85	25	105	25
SAD12040L	20	75	12	85	40	120	25
SAD12060L	20	75	12	85	60	140	25
SAD16015L	25	115	16	125	15	120	10
SAD16030L	25	115	16	125	30	130	10
SAD16060L	25	115	16	125	60	160	10

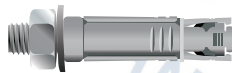
Projecting SAD-P

Product Code	Hole Diameter (mm)	Shield Length (mm)	Thread Diameter (mm)	Hole Depth (mm)	Fastening Thickness (mm)	Bolt Length (mm)	Box Quantity
SAD06010P	10	40	6	45	10	60	50
SAD06025P	10	40	6	45	25	70	50
SAD06050P	10	40	6	45	50	95	50
SAD08015P	14	50	8	55	15	75	50
SAD08040P	14	50	8	55	40	100	50
SAD08080P	14	50	8	55	80	140	25
SAD10010P	16	60	10	65	10	80	25
SAD10030P	16	60	10	65	30	100	25
SAD10050P	16	60	10	65	50	120	25
SAD10070P	16	60	10	65	70	140	25
SAD10090P	16	60	10	65	90	160	25
SAD12015P	20	80	12	90	15	110	25
SAD12025P	20	80	12	90	25	120	25
SAD12050P	20	80	12	90	50	140	10
SAD12070P	20	80	12	90	70	160	10
SAD16025P	25	100	16	110	25	140	10

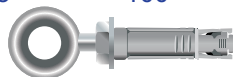
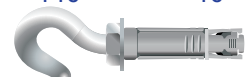
Eyebolt SAD-E**Hookbolt SAB-H**

Product Code	Hole Diameter (mm)	Shield Length (mm)	Thread Diameter (mm)	Hole Depth (mm)	Fastening Thickness (mm)	Bolt Length (mm)	Box Quantity
SAD06040E	SAD06040H	12	45	6	45	-	25
SAD08050E	SAD08050H	14	50	8	55	-	25
SAD10060E	SAD08050H	16	60	10	65	-	10
SAD12805E	SAD08050H	20	75	12	90	-	10

Sleeve Anchor SA



Description

The Sleeve Anchor is a thin wall sleeve anchor which is perhaps the most commonly used fixing. Suitable for Brickwork, Dense Blockwork and Concrete it is a low cost anchor both in supply and installation. Supplied as Zinc Plated, its variety of head styles such as Hex Nut, Hex Bolt, Countersunk, Roundhead, Hook and Eyebolt help it fulfil a vast range of applications. A Hex nut Stainless Steel version manufactured in A4-316 compliments the range for hostile environments including marine applications.

Applications

- Stadium Seating & Handrails
- Ductwork & Trunking
- Battens & Door Frames

Features & Benefits

- Fast installation
- Partial/ Full Corrosion Resistance
- Multi Style Customer Choice
- Proof Test Anchor on Installation
- Through fixing & Variety of Head Styles
- Zinc Plated & Stainless Steel
- Torque Controlled.

Installation Guide

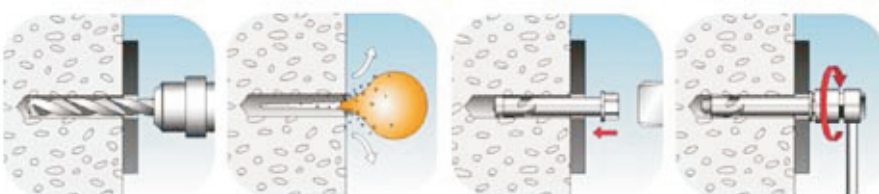

Flange Nut Type SA-N

Product Code	Length (mm)	Thread Diameter (mm)	Hole Depth (mm)	Fastening Thickness (mm)	Box Quantity
SA06018N	18	4.5	15	3	100
SA06025N	25	4.5	21	4	100
SA06040N	40	4.5	30	6	100
SA06060N	60	4.5	30	26	100
SA06075N	75	4.5	30	45	100
SA08040N	40	6	35	5	100
SA08065N	65	6	35	30	50
SA08085N	85	6	35	50	50
SA10040N	40	8	35	5	50
SA10050N	50	8	40	10	50
SA10060N	60	8	40	20	50
SA10075N	75	8	40	37	50
SA10100N	100	8	40	57	50
SA10125N	125	8	40	85	50
SA12060N	60	10	50	10	50
SA12075N	75	10	50	25	50
SA12100N	100	10	50	49	25
SA12125N	125	10	50	79	25
SA16065N	65	12	55	10	25
SA16110N	110	12	55	56	10
SA16145N	145	12	55	92	10

Hex Bolt Type SA-B

Product Code	Length (mm)	Thread Diameter (mm)	Hole Depth (mm)	Fastening Thickness (mm)	Box Quantity
SA08045B	45	6	35	10	100
SA08070B	70	6	35	35	50
SA08090B	90	6	35	55	50
SA10045B	45	8	40	5	50
SA10055B	55	8	40	15	50
SA10065B	65	8	40	25	50
SA10080B	80	8	40	40	50
SA10100B	100	8	40	60	50
SA10120B	120	8	40	80	50
SA12065B	65	10	50	15	50
SA12080B	80	10	50	30	50
SA12100B	100	10	50	50	25
SA12130B	130	10	50	80	25
SA16075B	75	12	55	20	25
SA16120B	120	12	55	65	10
SA16150B	150	12	55	95	10
SA20085B	85	16	60	25	10
SA20110B	110	16	60	50	10
SA20150B	150	16	60	90	10

Hex Bolt Plastic Ring SAP-B



Product Code	Length (mm)	Thread Diameter (mm)	Hole Depth (mm)	Fastening Thickness (mm)	Box Quantity
SAP08045B	45	6	43	5	100
SAP08050B	50	6	43	15	50
SAP09045B	45	6	43	5	100
SAP09060B	60	6	43	15	50
SAP10060B	60	8	55	5	50
SAP10080B	80	8	55	15	50
SAP11060B	60	8	55	5	50
SAP11080B	80	8	55	15	50
SAP12070B	70	10	70	5	25
SAP12100B	100	10	70	25	25
SAP14070B	70	10	70	5	25
SAP14100B	100	10	70	25	25
SAP16080B	80	12	80	5	25
SAP16110B	110	12	80	25	10
SAP20110B	110	16	90	15	10
SAP25130B	130	20	105	25	10

Forged Eyebolt Plastic Ring SAP-E

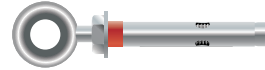

Product Code	Length (mm)	Thread Diameter (mm)	Hole Depth (mm)	Box Quantity
SAP08050E	50	6	35	100
SAP10050E	50	8	40	50
SAP12060E	60	10	50	25
SAP16000E	80	12	55	25

Forged Hook Bolt Plastic Ring SAP-H

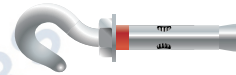

Product Code	Length (mm)	Thread Diameter (mm)	Hole Depth (mm)	Box Quantity
SAP08050H	50	6	35	100
SAP10050H	50	8	40	50
SAP12060H	60	10	50	25
SAP16000H	80	12	55	25

Projecting Bolt Plastic Ring SAP-P



Product Code	Length (mm)	Thread Diameter (mm)	Hole Depth (mm)	Fastening Thickness (mm)	Box Quantity
SAP08045P	45	6	43	5	100
SAP09045P	45	6	43	5	100
SAP09060P	60	8	55	5	50
SAP10080P	80	8	55	25	50
SAP11060P	60	8	55	5	50
SAP11080P	80	8	55	25	50
SAP12070P	70	10	70	5	25
SAP12100P	100	10	70	25	25
SAP14070P	70	10	70	5	25
SAP14100P	100	10	70	25	25
SAP16080P	80	12	80	5	25
SAP20110P	110	16	90	15	10
SAP25130P	130	20	105	25	10

Hex Nut SAS-NA2-304

Product Code	Length (mm)	Thread Diameter (mm)	Hole Depth (mm)	Fastening Thickness (mm)	Box Quantity
SAS06040NA2	40	4.5	21	8	100
SAS06060NA2	60	4.5	21	28	100
SAS08040NA2	40	6	35	8	100
SAS08065NA2	65	6	35	30	50
SAS08090NA2	90	6	35	55	50
SAS10050NA2	50	8	40	10	50
SAS10075NA2	75	8	40	35	50
SAS10100NA2	100	8	40	60	25
SAS12060NA2	60	10	50	15	25
SAS12075NA2	75	10	50	20	25
SAS12100NA2	100	10	50	50	20
SAS12125NA2	125	10	50	75	20

Hex Nut Type SAS-NA4-316

Product Code	Length (mm)	Thread Diameter (mm)	Hole Depth (mm)	Fastening Thickness (mm)	Box Quantity
SAS06040NA4	40	4.5	21	8	100
SAS06060NA4	60	4.5	21	28	100
SAS08040NA4	40	6	35	8	100
SAS08065NA4	65	6	35	30	50
SAS08090NA4	90	6	35	55	50
SAS10050NA4	50	8	40	10	50
SAS10075NA4	75	8	40	35	50
SAS10100NA4	100	8	40	60	25
SAS12060NA4	60	10	50	15	25
SAS12075NA4	75	10	50	20	25
SAS12100NA4	100	10	50	50	20
SAS12125NA4	125	10	50	75	20

Drop In Anchor DA



Description

The Drop In Anchor is a drop in anchor set to a specific depth. Traditionally installed in concrete it offers a permanent socket point that can be re-used. Available in both zinc plated and stainless steel A4-316 it is ideally suited to shallow applications.

Applications

- Scaffold Restraints
- Overhead M&E Support
- Ducting Pipework
- Heating and Ventilation
- Cable Trays
- Radiator & Brackets
- Cable Hangers
- Trunking
- Stadium Seating

Features & Benefits

- Rapid Installation
- One Piece Anchor with Captive Edge
- Shallow Embedment Depth
- Tapered Wedge Ensures Complete Expansion
- Stainless Steel and ZP Versions Available

Installation Guide

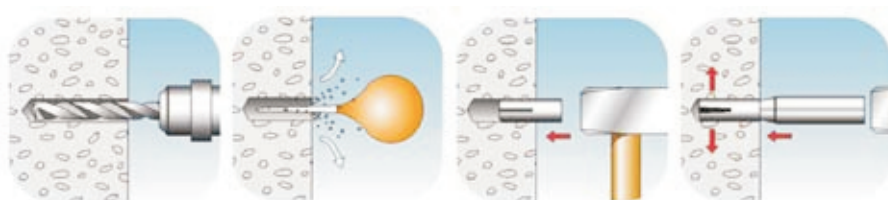

Steel DA

Product Code	Length (mm)	Hole Diameter (mm)	Box Quantity
DA06	25	8	100
DA08	30	10	100
DA10	40	12	50
DA12	50	15	50
DA16	65	20	25
DA20	80	25	25

Stainless Steel DAS

Product Code	Length (mm)	Hole Diameter (mm)	Box Quantity
DAS06	25	8	100
DAS08	30	10	100
DAS10	40	12	50
DAS12	50	15	50
DAS16	65	20	25
DAS20	80	25	25

Lipped Type DAL

Product Code	Length (mm)	Hole Diameter (mm)	Box Quantity
DAL06	25	8	100
DAL08	30	10	100
DAL10	30	12	100
DAL10	40	12	50
DAL12	50	15	50
DAL16	65	20	25

Drop In Anchor Tool DAT

Product Code	Cylinder Length (mm)	Cylinder Diameter (mm)	Stud Length (mm)	Stud Diameter (mm)
DAT06	150	8	15	4.5
DAT08	150	10	18	5.8
DAT10	150	12	24	7.2
DAT12	150	15	30	9.9
DAT16	150	20	39	13.2
DAT20	150	25	48	15.8

Cat.
B

Heavy Duty Sleeve Anchor HDS

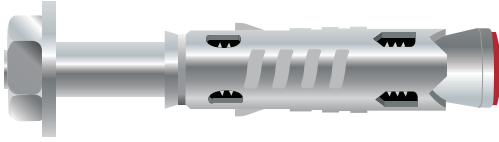

Description

The Heavy Duty Sleeve Anchor is perhaps the most versatile of all fixings used by the majority of trades. Suitable for Brickwork, Medium to Dense Blockwork and Concrete. It is ideal general purpose anchor that fulfils a large number of applications. The Shield version is particularly versatile when utilised with a wide variety of non-standard components, including special lengths of threaded rod where required.

Applications

- Machinery Installation
- Reinforcement
- Bracketry
- Racking & Storage
- Pipework
- Wall/ Sole Plates

Features & Benefits

- Zinc Plated/ A4-304 Stainless Steel
- Steel Manufactured
- Variety of Head Styles
- Torque Controlled
- Partial Corrosion Resistance
- Fire Resistance
- Multi Style Customer Choice
- Proof Test Anchor on Installation

Installation Guide

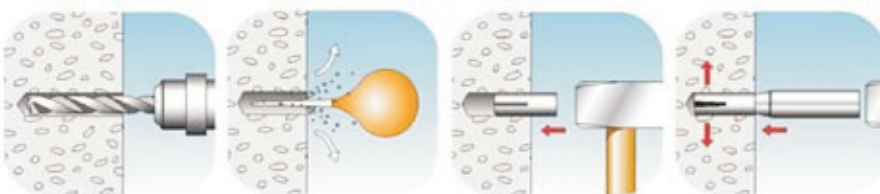

www.safeguardanchors.com

Steel Shield Only HDA-S

Product Code	Hole Diameter (mm)	Length (mm)	Thread Diameter (mm)	Hole Depth (mm)	Fastening Thickness (mm)	Bolt Length (mm)	Box Quantity
HDA06S	10	45	6	50	5	55	100
HDA08S	12	50	8	55	10	60	100
HDA10S	15	60	10	65	20	80	100
HDA12S	18	75	12	80	25	100	50

Steel Loosebolt HDA-SL

Product Code	Hole Diameter (mm)	Length (mm)	Thread Diameter (mm)	Hole Depth (mm)	Fastening Thickness (mm)	Bolt Length (mm)	Box Quantity
HDA06SL	10	45	6	50	5	55	100
HDA08SL	12	50	8	55	10	60	100
HDA10SL	15	60	10	65	20	80	100
HDA12SL	18	75	12	80	25	100	50

Stainless Steel Shield Only HDA-SS

Product Code	Hole Diameter (mm)	Length (mm)	Thread Diameter (mm)	Hole Depth (mm)	Fastening Thickness (mm)	Bolt Length (mm)	Box Quantity
HDA06SS	10	45	6	50	5	55	100
HDA08SS	12	50	8	55	10	60	100
HDA10SS	15	60	10	65	20	80	100
HDA12SS	18	75	12	80	25	100	50

Stainless Steel Loosebolt HDA-SSL

Product Code	Hole Diameter (mm)	Length (mm)	Thread Diameter (mm)	Hole Depth (mm)	Fastening Thickness (mm)	Bolt Length (mm)	Box Quantity
HDA06SSL	10	45	6	50	5	55	100
HDA08SSL	12	50	8	55	10	60	100
HDA10SSL	15	60	10	65	20	80	100
HDA12SSL	18	75	12	80	25	100	50

Scaffold Screws SS

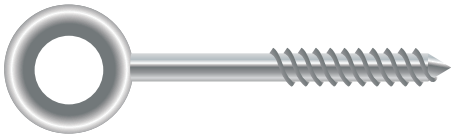

Description

The Scaffold Screws with eye diameter of 23mm is ideal fastening in connection with the scaffold plug. Available in Scaffold Forged Eyebolt and Scaffold Eyescrews.

Applications

- Fixing facade scaffolds
- Climbing Scaffolds
- Tensioning ropes and chains.

Features & Benefits

- Setting depth marks for controlled screwing by visual inspection.
- Welded scaffold screw for a safer fixing
- Economical solution for light scaffolds.
- Safe bridging of plaster and insulation material.

Installation Guide

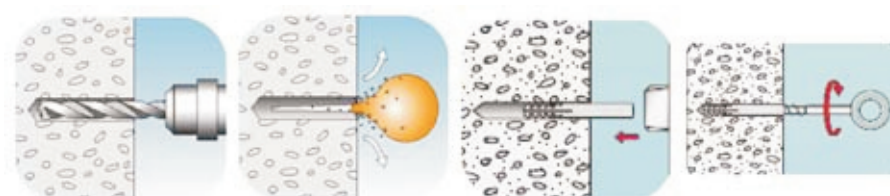

Scaffold Forged Ring Bolt SFB

Product Code	Length (mm)	Hole Diameter (mm)	Box Quantity
SFB10220	220	16	10
SFB10270	270	16	10
SFB12220	220	18	12

Scaffold Screw EyeBolt SSE

Product Code	Cylinder Length (mm)	Cylinder Diameter (mm)	Stud Length (mm)	Stud Diameter (mm)
SSE12090	90	15	23	25
SSE12120	120	45	23	25
SSE12160	160	85	23	25
SSE12190	190	115	23	25
SSE12230	230	155	23	25
SSE12300	300	225	23	25
SSE12350	350	275	23	25



Chemical Anchor Studs

CAS

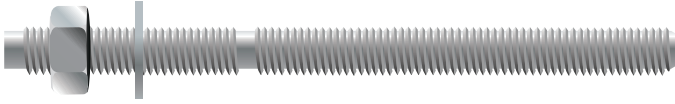

Description

The Chemical Anchor Stud is a chisel ended anchor for use with any injection systems and glass capsules in masonry and concrete. On installation the stud becomes chemically bonded to the base material. Notably the fixing method imposes no expansion stress on the base material, and is ideal for shock or vibratory loadin and softer or low density building materials where expansion stresses would normally result in failure.

Applications

- Structural Steelworks
- Heavy Machinery
- Structural Cladding
- Safety Barriers
- Heavy Duty Bracketry

Features & Benefits

- Stress Free Fixing
- Good Load Performance
- Available in Two Versions
- Use with Studs and Sockets
- Fast Installation
- Increased Load Potential
- Surrounding Base Material Reinforced
- Ideal for Reducing Space

Installation Guide

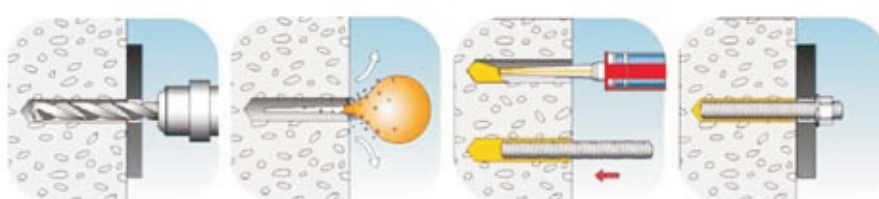

Chemical Anchor Studs CAS

Product Code	Length (mm)	Hole Diameter (mm)	Hole Depth (mm)	Fastening Thickness (mm)	Box Quantity
CAS08110	110	10	80	20	10
CAS10130	130	12	90	40	10
CAS12160	160	14	110	40	10
CAS16190	190	28	125	45	10
CAS20260	260	25	170	85	10
CAS24300	300	28	210	120	5

Chemical Anchor Studs CAS-S

Product Code	Length (mm)	Hole Diameter (mm)	Hole Depth (mm)	Fastening Thickness (mm)	Box Quantity
CAS08110S	110	10	80	20	10
CAS10130S	130	12	90	40	10
CAS12160S	160	14	110	40	10
CAS16190S	190	28	125	45	10
CAS20260S	260	25	170	85	10
CAS24300S	300	28	210	120	5

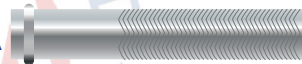
Chemical Resin Anchor Socket CRA

Product Code	Length (mm)	Thread Size (mm)	Box Quantity
CRA10048	48	6	10
CRA14080	80	8	10
CRA16080	80	10	10
CRA18080	80	12	10

Metal Frame Anchor MFA



Description

The Metal Frame Anchors are designed for fixing all types of frames to concrete and other hard base materials. The steel sleeve provides a high bend resistance and strong pullout loads. The retention lugs locate the outer section of hollow frames and give a strong friction grip in timber. Frame position may be adjusted during installation and the Metal Frame Anchors may be adjusted or removed at any time.

Applications

- Fixing window and door frames made of metal, timber or plastic
- Fireproof Doors
- Battens

Features & Benefits

- Steel Sleeve- High Bend Resistance
- Machined screw - Strong pullout loads
- Frame retaining lugs
- Anti-rotation fins
- Corrosion protection

Installation Guide

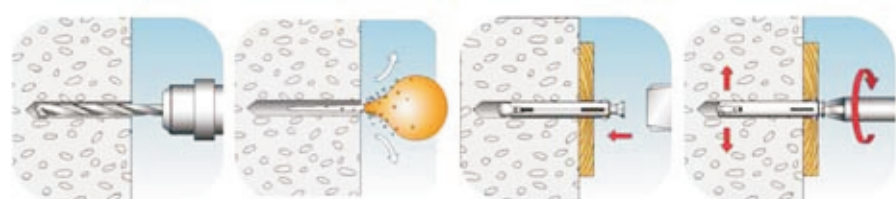

Metal Frame Anchor MFA



Product Code	Anchor Length (mm)	Hole Depth (mm)	Fastening Thickness (mm)	Screw Head Dia. (mm)	Screw Thread Dia. (mm)	Box Quantity
MFA10072	72	70	25	13	6	100
MFA10092	92	70	40	13	6	100
MFA10112	112	70	60	13	6	100
MFA10132	132	70	80	13	6	100
MFA10152	152	70	100	13	6	100
MFA10182	182	70	130	13	6	100
MFA10202	202	70	150	13	6	100

Cat.
B

Category **B** Medium Duty Anchors



Cat.
B

uPVC Window Frame Anchor WFA



Description

The Window Frame Anchor is specially designed for fixing of uPVC and aluminium frames. The retaining lugs at the top of the sleeve allow the frame to be located in the desired position without distortion. This fixing can be used to fix into concrete, stone, solid brickwork, perforated brickwork, rock and concrete block.

Applications

- Neat Firm Fixing
- Door and Window Frames
- uPVC and aluminium
- Dense concrete
- Solid brick
- Perforated Bricks
- Aircrete
- Natural Stone

Features & Benefits

- Anti rotation fins
- Zinc plated screw for corrosion resistance
- Retaining collar
- Captive expander cone
- Comes complete with cover caps

Installation Guide

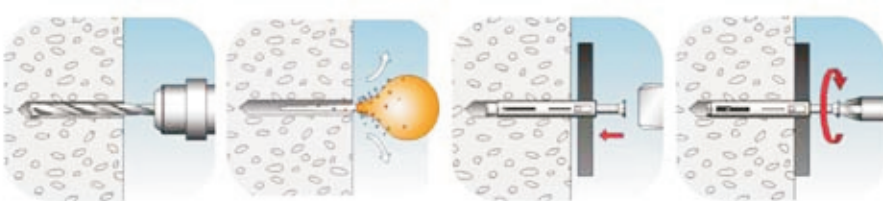

www.safeguardanchors.com

Category **B** Medium Duty Anchors

uPVC Window Frame Anchor WFA



Product Code	Anchor Length (mm)	Hole Depth (mm)	Fastening Thickness (mm)	Screw Head Dia. (mm)	Screw Thread Dia. (mm)	Box Quantity
WFA08100	100	65	50	10	5	50
WFA08120	120	65	70	10	5	50
WFA08140	140	65	90	10	5	50
WFA10075	75	75	15	12	6	50
WFA10100	100	75	40	12	6	50
WFA10120	120	75	60	12	6	50
WFA10140	140	75	80	12	6	50
WFA10165	165	75	105	12	6	50

Cat.
B

Category **B** Medium Duty Anchors

